



Versatile manual backpack sprayer with 20 litre capacity. It includes a selection of nozzles that allows different types of application. Sprayer suitable for use in large gardens.



Advantages

- Greater strength and performance to agrochemicals thanks to the quality of its materials (FPM seal and joints, stainless steel handle and reinforced hose).
- Nozzles included (4 holes and white mirror) for different applications and crops.
- Maintenance without tools.
- Homogeneous treatment thanks to the pressure regulator.
- Possibility of mixing inside the tank thanks to the translucent liquid level indicator.
- Ambidextrous and lightweight keeping the ergonomics.
- Suitable for application of products of natural origin (pelargonic, acetic, etc...).



Technical information

| Technical information | EVOLUTION 20 SUPER |
|--|---|
| HOSE | 1.3 m (Reinforced PVC) |
| STANDARD NOZZLES | Adjustable conical + 4 holes |
| LANCE | Fibreglass (71 cm) |
| USABLE CAPACITY | 20 L |
| TOTAL CAPACITY | 21 L |
| LITRES/MIN. 1,5 BAR | 0,56 l/min |
| LITRES/MIN. 3 BAR | 0,80 l/min |
| NET WEIGHT | 3,76 Kg |
| INTEGRATED SYSTEM TO RELEASE THE CYLINDER WITHOUT EMPTYING | YES |
| WIDE FILLER OPENING | YES |
| SET OF NOZZLES FOR HERBICIDE AND INSECTICIDE TREATMENTS | YES |
| REINFORCED PRESSURE CHAMBER | YES |
| TRANSLUCENT LEVEL INDICATOR | YES |
| STANDARD ACCESSORIES | Pressure regulator, set of nozzles (herbicide elbow plus fan, mirror and disc nozzles), 4-hole nozzle, two seals (1 rubber and 1 synthetic) and a dispenser |
| LANCE AND EXTENSIONS | Lance/Lever |
| STRAPS | Adjustable and padded |
| CHAMBER SEAL | FPM |
| PRESSURE REGULATOR | YES (FPM - 3 positions) |
| HANDLE | Stainless steel |

Logistics data

| Logistics Data | EVOLUTION 20 SUPER |
|-----------------------|--------------------|
| CODE | 8.49.48 |
| EAN | 84.14685.20102.7 |
| CONDITIONING | 1 unit |
| UNITS PER PALLET | 14 units |
| DIMENSIONS PER PALLET | 1200 X 800 X 1020 |

MAINTENANCE KITS



PR MAINTENANCE KIT
Reference 8.39.41.870
Keep your sprayer at peak performance. Designed for 12-20 L sprayers.

| | | |
|-----------------------------------|-------------|--|
| ROUND SEAL AN-8 No. 101 | 2.23.15.908 | |
| STAINLESS STEEL BALL Ø 12 No. 119 | 2.20.08.902 | |
| VITON SEAL No. 120 | 8.39.11.305 | |
| ROUND SEAL AN-5 No. 136 | 2.23.15.905 | |
| CHAMBER VALVE No. 365 | 8.39.41.303 | |
| FILTER WASHER No. 1034 | 8.49.41.410 | |

Functional information

| | | | | | | | | | | |
|------------------------|-------------------------------|-----------------------------------|---------------------|--|--|---|------------------|-----------------------|------------------------------------|--------------------------|
| | | | | | | | | | | |
| Stainless steel handle | 3-position pressure regulator | Ergonomic and robust clamping nut | Lance/lever support | Integrated system to release the cylinder without emptying | Reinforced chamber with FPM retainer for intensive use | Integrated and comfortable transport handle | Fibreglass lance | Large filling opening | Translucent liquid level indicator | Adjustable padded straps |



ACCESSORIES

Personalize your sprayer adapting it to your application needs (height, hard-to-reach areas...)



3.2 M TELESCOPIC LANCE
Reference 8.35.40.913
5.4 M TELESCOPIC LANCE
Reference 8.35.40.915



4-HOLE NOZZLE
Reference 8.34.46.801

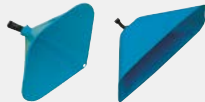

CONICAL HOOD
Reference 8.34.40.870
RECTANGULAR HOOD
Reference 8.34.40.871



QUADRUPLE BOOM
Reference 8.34.60.870



DOUBLE ADJUSTABLE NOZZLE
Reference 8.34.46.802



**PRESSURE
REGULATOR
(EVOLUTION - AGRO
GREEN TYPE)**
Reference
8.35.47.870



ANTI-DRIFT NOZZLE (INDUCED AIR) 80°
Reference 8.34.46.814
ANTI-DRIFT NOZZLE (INDUCED AIR) 120°
Reference 8.34.46.804



LOW-VOLUME WEED-KILLERS ELBOW
Reference 8.34.60.935



**1 M FIBREGLASS LANCE TUBE WITH
COMPLETE ELBOW**
Reference 8.34.60.873
**1.5 M FIBREGLASS LANCE TUBE WITH
COMPLETE ELBOW**
Reference 8.34.60.874

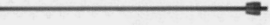

EXTENSION 0.5M
Reference 8.35.40.871



FLEXIBLE DOUBLE NOZZLE
Reference 8.35.40.871



NOZZLE SET
Reference 8.34.46.870



TELESCOPIC EXTENSION
Reference 8.35.40.876

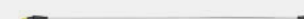

**1 M ALUMINIUM LANCE TUBE WITH
COMPLETE ELBOW**
Reference 8.34.60.871
**1.5 M ALUMINIUM LANCE TUBE WITH
COMPLETE ELBOW**
Reference 8.34.60.872

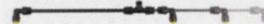

EXTENDIBLE DOUBLE NOZZLE
Reference 8.35.40.872



NORMAL WEED-KILLERS ELBOW
Reference 8.34.60.934

SPARE PARTS

Extend the service life of your sprayer easily replacing parts

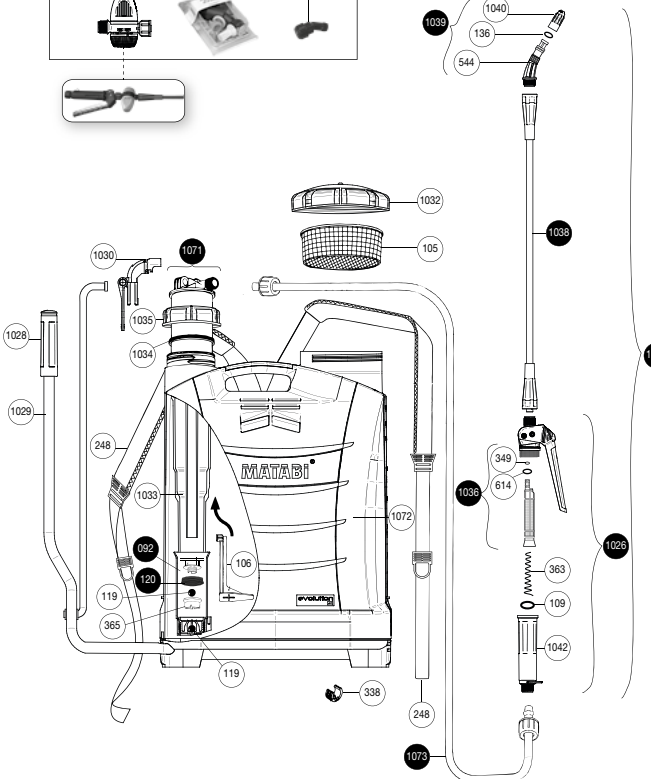
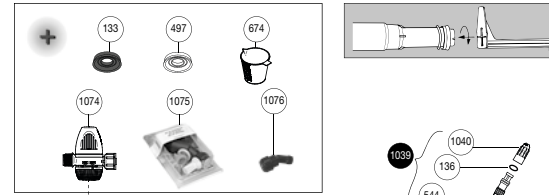

| N. | COD. | Q | SPARE PARTS NAME |
|------|---------------|---|------------------------------|
| 92 | 8.39.41.603 | 1 | CYLINDER WITH BALL |
| 105 | 8.39.18.303 | 1 | FILTER TANK |
| 106 | 8.39.47.306 | 1 | AGITATOR |
| 109 | 2.23.15.916 | 1 | ROUND GASKET AN-16 |
| 119 | 2.20.08.902 | 2 | STAINLESS STEEL BALL Ø 12 |
| 120 | 8.39.11.305 | 1 | VITON SEAL |
| 133 | 8.39.09.306 | 1 | RUBBER SEAL |
| 136 | 2.23.15.905 | 1 | ROUND GASKET AN-5 |
| 248 | 8.39.41.364 | 2 | STRAP |
| 338 | 8.39.43.327 | 1 | BASE BUSHING |
| 349 | 2.23.16.903 | 1 | ROUND GASKET AN-3 |
| 363 | 8.39.41.342 | 1 | FILTER SPRING |
| 365 | 8.39.41.303 | 1 | SEALING VALVE |
| 497 | 8.39.41.305 | 1 | OPAQUE SYNTHETIC SEAL |
| 544 | 8.28.40.322 | 1 | SPRAYER |
| 614 | 2.23.16.908 | 1 | ROUND GASKET AN-8 |
| 674 | 8.39.41.350 | 1 | 100 ML DOSER |
| 1026 | 8.49.41.801 | 1 | COMPLETE HANDLE |
| 1028 | 8.49.41.307 | 1 | GRIP |
| 1029 | 8.49.41.802 | 1 | COMPLETE LEVER |
| 1030 | 8.49.41.811 | 1 | LANCE HOOK |
| 1032 | 8.49.41.602 | 1 | TANK COVER AND VALVE |
| 1033 | 8.49.41.302 | 1 | PRESSURE CHAMBER |
| 1034 | 8.49.41.410 | 1 | LOCKING WASHER |
| 1035 | 8.49.41.304 | 1 | GUIDE LID |
| 1036 | 8.49.41.812 | 1 | FILTER WITH GASKET |
| 1037 | 8.49.41.823 | 1 | COMPLETE LANCE |
| 1038 | 8.49.41.627 | 1 | TUBE WITH NUTS |
| 1039 | 8.49.41.808 | 1 | ELBOW WITH NOZZLE |
| 1040 | 8.49.41.315 | 1 | NOZZLE Ø 1,5 |
| 1042 | 8.49.41.367 | 1 | GRIP |
| 1071 | 8.49.48.814 | 1 | COMPLETE CHAMBER |
| 1072 | 8.49.48.850 | 1 | 20 L. TANK |
| 1073 | 8.49.41.805 | 1 | COMPLETE HOSE |
| 1074 | 8.34.47.800.3 | 1 | PRESSURE REGULATOR |
| 1075 | 8.34.46.816 | 1 | NOZZLES SET |
| 1076 | 8.34.46.801 | 1 | 4 HOLE NOZZLE |
| | 8.49.48.200 | 1 | INSTRUCTION SHEET |
| | 8.49.48.201 | 1 | EVOLUTION 20 SUPER PACKAGING |